

CDM-ISO-PHS/PHR

SYSTEM DATASHEET



彈性吊架



CDM-ISO-PHS/PHR彈性吊架可吊起笨重的天花板，牆壁，照明鑽機及管道等。通過將這些構件從主結構中隔離分開達致最佳的隔音和防振效果。

選用CDM-ISO-PHS或CDM-ISO-PHR，取決於所要求的共振頻率和實際荷載。

可根據所要求的固有頻率制造承受不同荷載的吊架（例如3赫茲的彈簧吊架）
安裝指南：

CDM-ISO-PERIMETER-STRIP應用於天花板的周邊部位，以確保懸浮構件與主要結構隔離。



f_{res} [Hz]	Type	Optimal load per element [N]
ca. 8 – 10 Hz	ISO-PHS-150	150 (min: 100 – max: 250)
	ISO-PHS-500	500 (min: 250 – max: 600)
	ISO-PHS-1000	1000 (min: 600 – max: 1000)
	ISO-PHS-1400	1200 (min: 1000 – max: 1800)
ca. 4 – 5 Hz	ISO-PHR-150	150 (min: 120 – max: 180)
	ISO-PHR-500	500 (min: 400 – max: 600)
	ISO-PHR-1000	1000 (min: 800 – max: 1200)

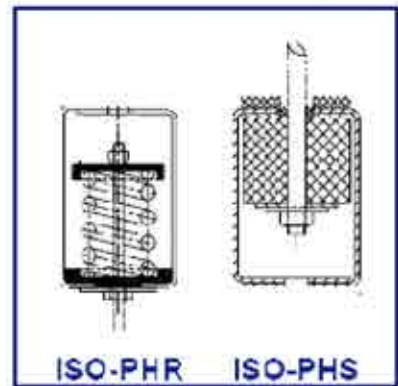

Example: Installation of a CDM-ISO-PHS wall

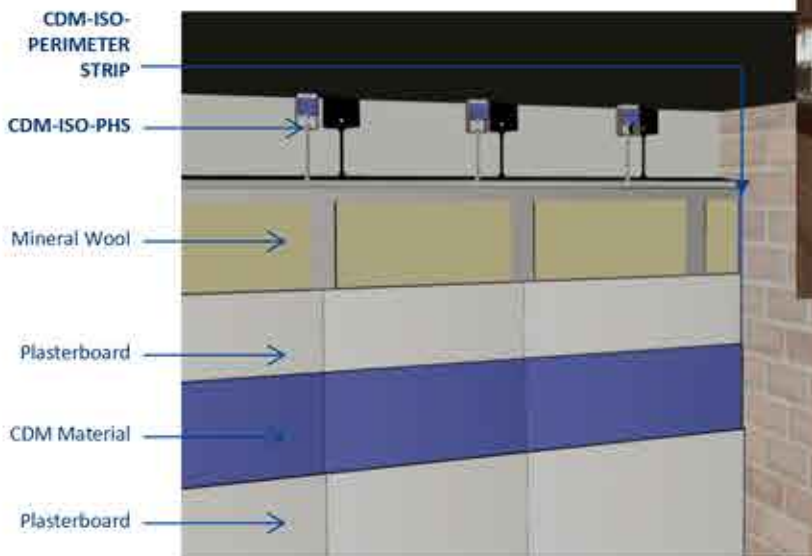

Required Data for Design:

- required performance, e.g. insertion loss or natural frequency
- imposed permanent and temporary working loads
- contact surface (type and dimensions)

CDM-ISO-WALL/CEILING

